

Technical data

Type	max. flow rate* (l/h)				max. pressure (bar)*	Connections F	Material in contact with metered liquid
	Stroke frequency min ⁻¹	50	72	100			
PS 3	0.16	0.23	0.32	0.46			
PS 5	0.40	0.57	0.80	1.15	80	G 1/4 female	1.4571
PS 8	1.05	1.51	2.10	3.00			
PS 10	3.20	4.80	6.40	9.60	80		
PS 16	8.60	12.30	17.20	24.70	80	G 3/8 female	1.4571 / 1.4581
PS 25	21.00	30.20	42.00	60.50	32		

* In the case of multiple pumps with 4-6 pump heads the maximum pressure is 50% of the value given in the table.

Type PS 3 to PS 8

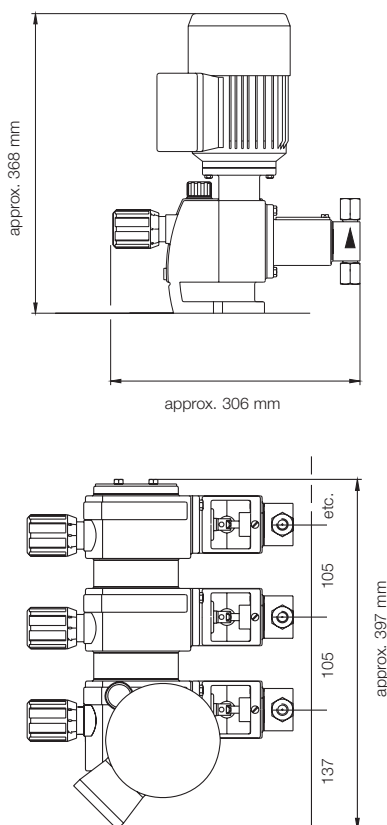

Type PS 10 to PS 25

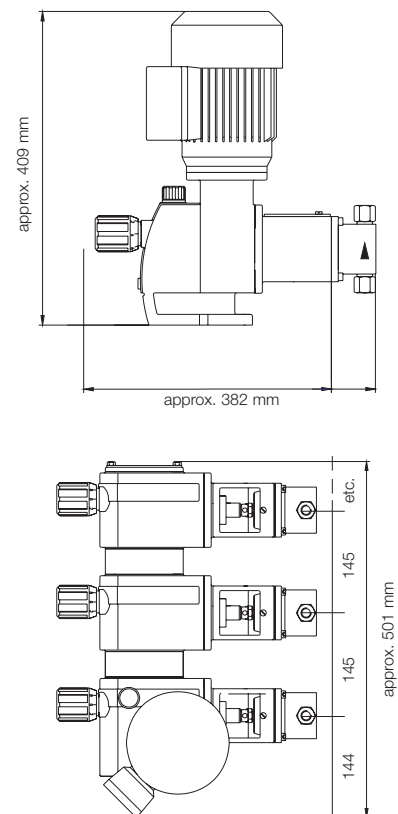

Operating conditions

Ambient temperature	0°C to 40°C
Temperature of metered fluid	0°C to 80°C

Drive motor

Standard	230/400 V; 50/60 Hz; IP 55; ISO KL. F
PS 3, PS 5, PS 8:	0,18 kW; 1400 rpm and 2800 rpm
PS 10, PS 16, PS 25:	0,37 kW; 1400 rpm or 0,55 kW, 2800 rpm

(Other motors on request)